

## JDG2-1500



### General Features

- > Nanosilica colloidal electrolyte and high tin positive plate alloy design to enhance battery performance
- > Relatively rich electrolyte, high temperature and low temperature performance is superior
- > Long cycle life, excellent deep cycle discharge ability
- > Excellent charge acceptance ability
- > Precision sealing technology
- > Long life



Dimension: 401(L)×351(W)×342(H)×378(TH) Unit: mm

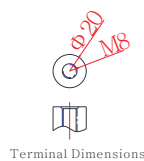
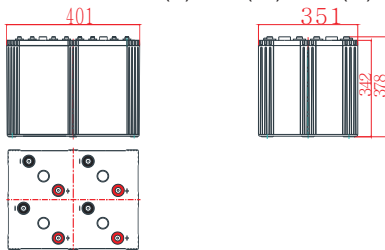

Terminal Dimensions

### Applications

- > Solar / wind energy and other new energy storage
- > UPS/EPS
- > Power systems
- > Telecommunications system
- > Emergency lighting、Auto control system
- > Other general purpose

### Specification

Nominal Voltage	2V		
Nominal Capacity	1500Ah		
Design life	12 years		
Terminal	M8		
Approx. Weight	Approx 96.0kg (212lbs)		
Container Material	ABS		
Rated Capacity	1500Ah	10Hour Rate	(150A to 1.80V)
	1131Ah	3Hour Rate	(377A to 1.80V)
	846Ah	1Hour Rate	(846A to 1.75V)
Internal resistance	Full charged at 25°C: 0.20 mΩ		
Max. Discharge Current	12000A(5S)		
Operating Temperature	Discharge: -40 ~60°C (-40~ 140°F)		
	Charge: -20 ~50°C (-4~ 122°F)		
	Storage: -20 ~50°C (-4~ 122°F)		
Charge current:	Max.300A ; Recom.150A		
Charge Method (25 °C)	Float Charge: 2.23-2.27V, recom. 2.25V (-3mV/ °C)		
	Equalize charge: 2.30-2.35V, recom. 2.35V (-4mV/ °C)		
	Cycle charge: 2.40-2.50V, recom. 2.40V (-5mV/ °C)		
Self discharge	3% of capacity declined per month at 25°C		

### Constant Current Discharge Characteristics Unit: A (25°C, 77°F)

FV/Time	30min	1h	2h	3h	5h	8h	10h	20h
1.60V	1549	980	578	424	285	194	162	86.7
1.65V	1454	929	564	413	278	191	160	85.9
1.70V	1365	888	543	401	276	188	158	84.7
1.75V	1268	846	524	389	268	186	155	83.4
1.80V	1187	793	496	377	262	182	150	80.1
1.85V	1058	722	462	358	253	177	148	79.3

### Constant Power Discharge Characteristics Unit: W (25°C, 77°F)

FV/Time	30min	1h	2h	3h	5h	8h	10h	20h
1.60V	2831	2019	1213	890	602	408	342	183
1.65V	2721	1866	1174	858	583	402	334	179
1.70V	2611	1776	1130	825	573	393	324	174
1.75V	2522	1707	1089	793	558	378	319	171
1.80V	2433	1608	1038	766	542	369	314	169
1.85V	2164	1487	949	726	518	357	302	162

## JDG2-1500

Discharge characteristic

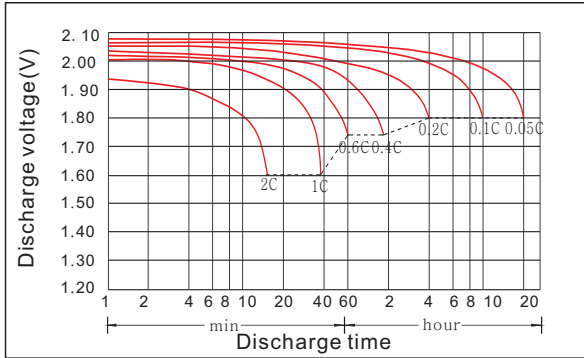

Charging characteristic

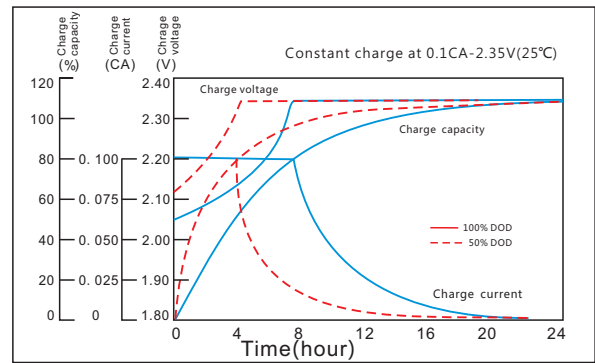

The effect of temperature on capacity

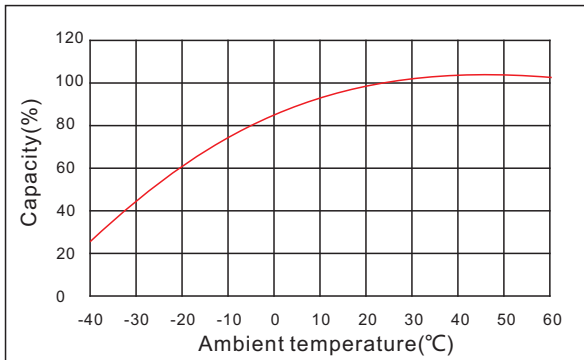

The effect of discharge depth on cycle life

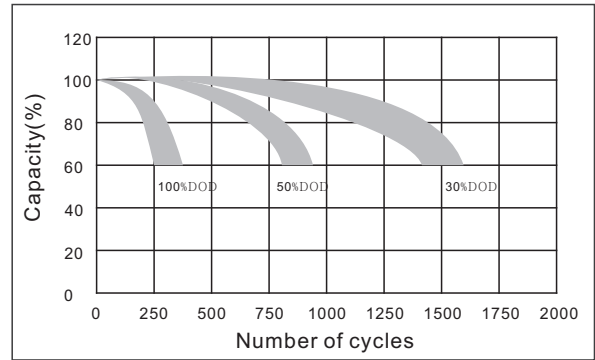

Curves of self-discharge

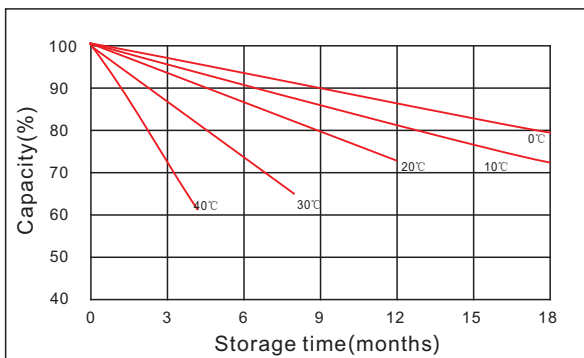

Curves of open circuit voltage vs. capacity

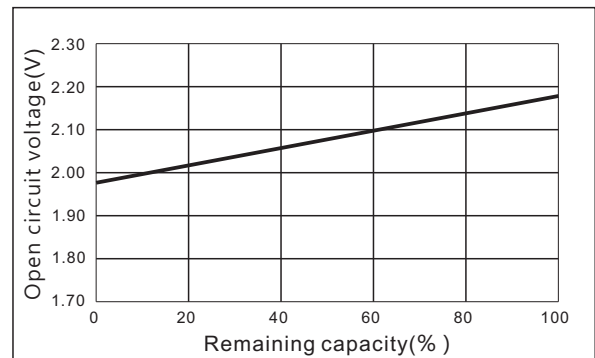

[www.kijo.com.cn](http://www.kijo.com.cn)    [info@kijo.com.cn](mailto:info@kijo.com.cn)

**Jiangxi Jingjiu Power Science&Technology Co. Ltd.**  
Add: 1388 Fushan No.1 Street, Xiaolan Economic Development Zone, Nanchang City, Jiangxi Province, China.

+86-791-85982779    +86-791-85989842

**Jiangxi Jingjiu Power ( Jiujiang ) Co. Ltd.**  
Add: Xiwang Rd, Aicheng Industrial Park, Yongxiu Country, Jiujiang City, Jiangxi Province, China.

